

Joint Meeting
Music Library Association, Atlantic Chapter (AtMLA)
American Musicological Society, Capital Chapter (AMS-CC)
Friday, October 18 - Saturday, October 19, 2024

Program: <https://atmla.wp.musiclibraryassoc.org/fall-2024-meeting-general-info/>

Abstracts: <https://atmla.wp.musiclibraryassoc.org/fall-2024-meeting-abstracts/>

Directions

The meeting will be held in the Library of Congress Madison Building, 101 Independence Ave. SE, Washington, DC 20540.

Main entrance is on Independence Ave.

There is no public parking in the library buildings. Paid parking information in the surrounding area can be found here:

<https://atmla.wp.musiclibraryassoc.org/fall-2024-meeting-accomodations/>

If you are taking the Metro (<https://wmata.com/>), the closest stop is Capitol South (Orange/Blue/Silver Lines) - the exit will put you on First Street SE. Go up the hill towards the Madison Building and turn right to get to the main entrance on Independence Ave.

If you are taking the MARC (<https://www.mta.maryland.gov/welcome-back-to-marc>) or Amtrak train (<https://www.amtrak.com/home.html>), get off at the Washington Union Station station stop. Cross Columbus Circle and walk south on First St. for 5 blocks until you reach Independence Ave. Cross Independence Ave. (past the Jefferson Building) and enter the Madison Building.

Maps are at the end of this document.

Security at entrance/exit

The Library of Congress buildings require going through Capitol Police security gates in order to enter. Put all belongings on the x-ray conveyor belt. Remove all items with metal in them (belts, watches, loose change, some jewelry will set off the alarm) and place them in the provided tray. Put laptops in a separate tray. You will not need to take off your shoes unless they have metal in them. Walk through the gate and collect your belongings at the end. Capitol Police will confiscate items that they deem as dangerous, so please leave them at home.

When exiting the building, you will need to open your bag to the police, and if you have a laptop, you will be required to show this as well.

Once inside the Madison Building

Turn right just past the hall to the elevators. Take the elevator to the **6th floor**. The meeting will be held in **Dining Room A** (which is a meeting space, not a dining hall) in the **Yellow Corridor**.

A display of Music Division collection items will be in the **West Dining Room** on Friday during check-in only.

Wi-fi info: There is free wi-fi in the building. Information can be found at <https://www.loc.gov/rr/wirelessaccess.html>

Concert and Tour of the Jefferson Building

Information about the Friday morning tour and Friday evening concert will be sent separately. Concert tickets have been distributed via email to those who had indicated interest on the registration form. There are a limited number of tickets remaining - contact Janet McKinney (jmckinney@loc.gov) if you wish to attend the concert or tour.

Meals

Friday evening, 5:30 pm

We have made reservations at
Hawk 'N' Dove
329 Pennsylvania Ave SE, Washington, DC 20003
<https://www.hawkndovebardc.com/>

Separate checks will be requested.

Saturday morning, before sessions

Breakfast foods will be provided, courtesy of AMS-CC.

Saturday afternoon

A boxed lunch from Whole Foods will be provided, courtesy of AtMLA. An order form has been sent to those who have indicated interest. Note that the lunch is concurrent with the business meetings.

For presenters:

IMPORTANT

You must have all of your presentation material on a USB drive. All presenters will be using the Library of Congress presentation computer that will be provided. The Internet speed in the meeting room may not be sufficient for accessing websites or videos, due to government security measures placed on Internet connections.

Uploading presentations after the meeting

AtMLA has an open access repository for chapter presentations at <https://atmla.hcommons.org/>
If you would like to add your presentation, please follow the instructions at [AtMLA Humanities Commons Presentation Uploading Instructions](#) For AtMLA members, if you would like to join the AtMLA Knowledge Commons Group, follow the instructions at the bottom of the instructions document.

Maps

<https://www.loc.gov/visit/maps-and-floor-plans/>

Capitol Hill: <https://www.loc.gov/visit/maps-and-floor-plans/capitol-hill/>

Jefferson Building, Ground Floor:

<https://www.loc.gov/visit/maps-and-floor-plans/thomas-jefferson-building/ground-floor/>

Madison Building, First Floor:

<https://www.loc.gov/visit/maps-and-floor-plans/james-madison-memorial-building/first-floor/>

Madison Building, Sixth Floor:

<https://www.loc.gov/visit/maps-and-floor-plans/james-madison-memorial-building/sixth-floor/>

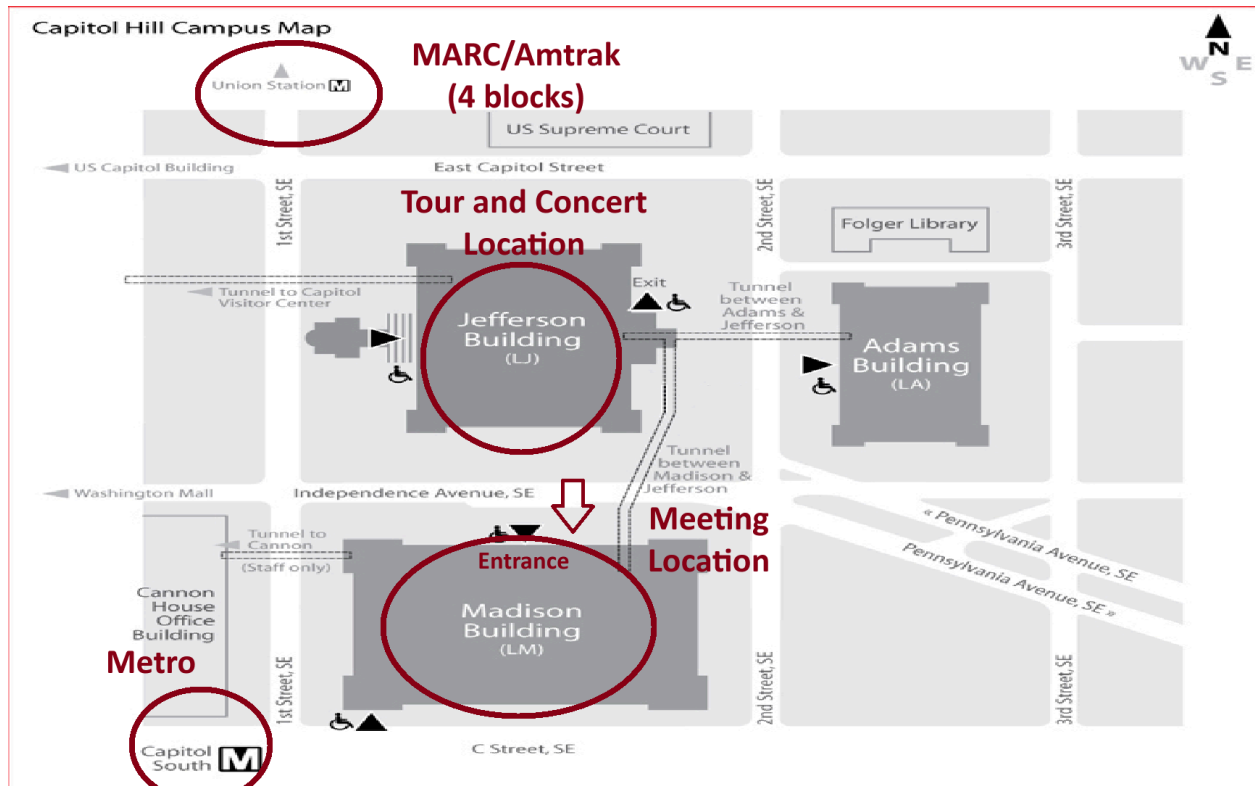

Thomas Jefferson Building (LJ)
Ground Floor (G)

2ND STREET, SE

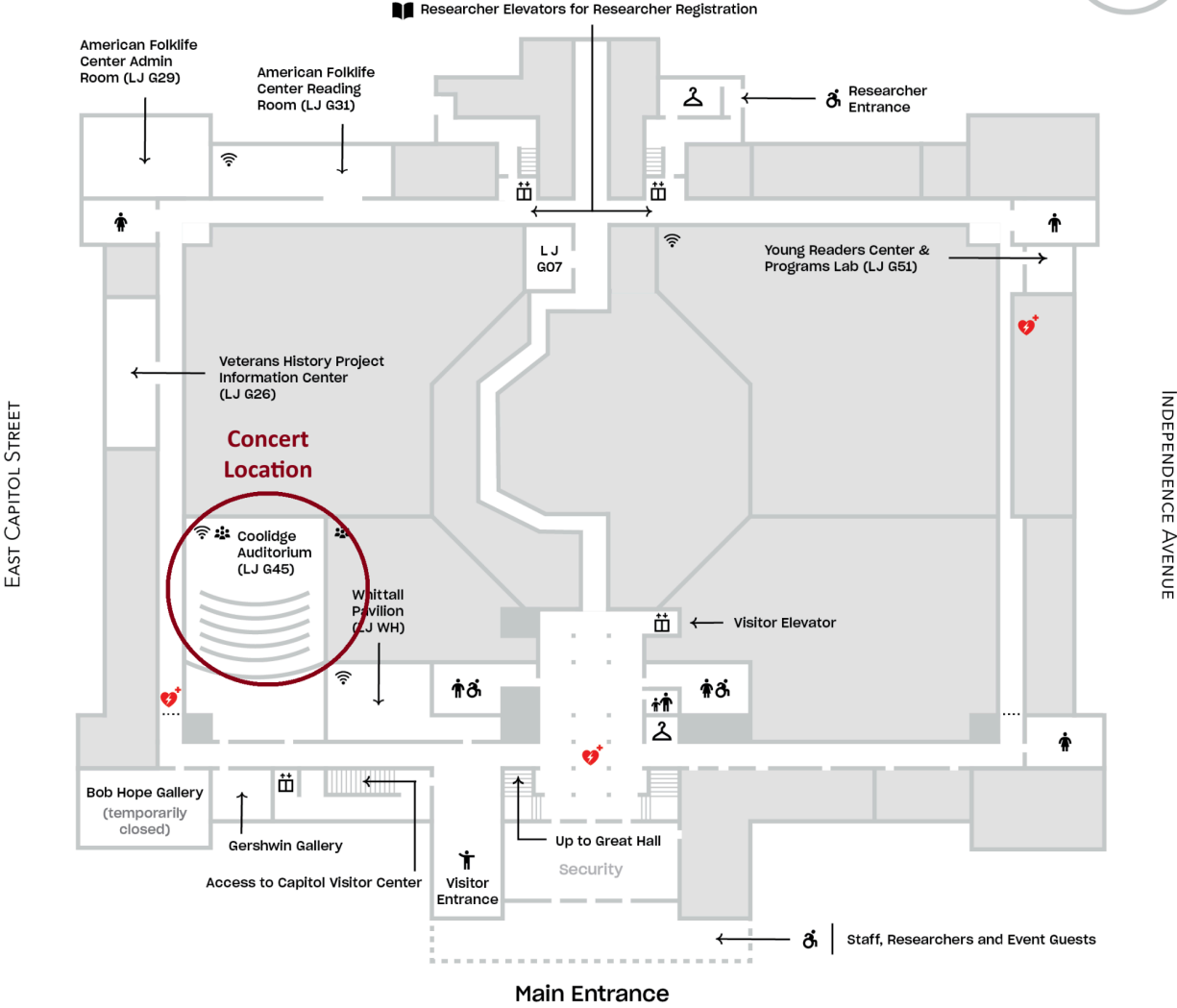

1ST STREET, SE

James Madison Memorial Building (LM)
First Floor (1)



C STREET, SE

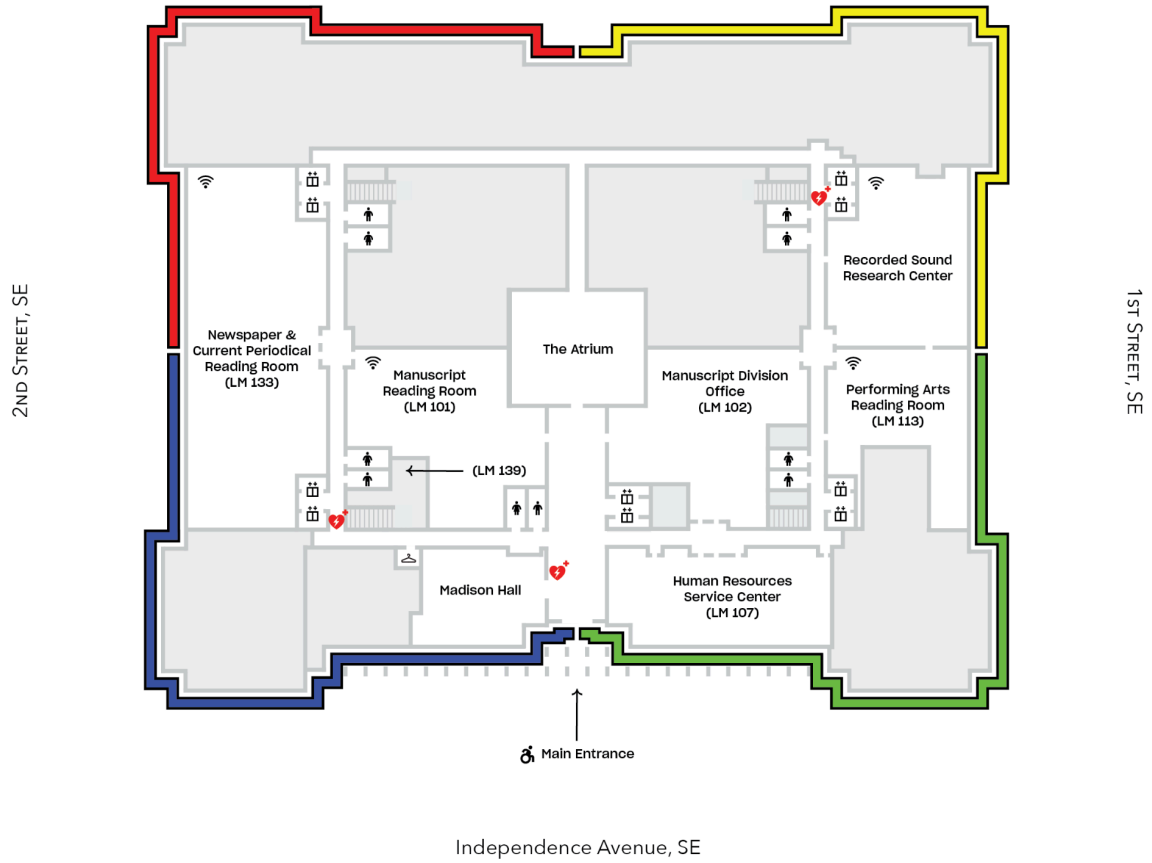

Independence Avenue, SE

James Madison Memorial Building (LM)
Sixth Floor (6)

